



NPCA
Precast ... The Concrete Solution.



120 CLAY PIT ROAD
MARSHFIELD, MA 02050
PHONE # 1-800-440-0009
FAX # 781-837-4320

CONTRACTOR:		JOB NAME:
DATE:	APPROVED BY:	DRAWING BY: C. J. SCOTT
OPEN BOTTOM BOX CULVERT		

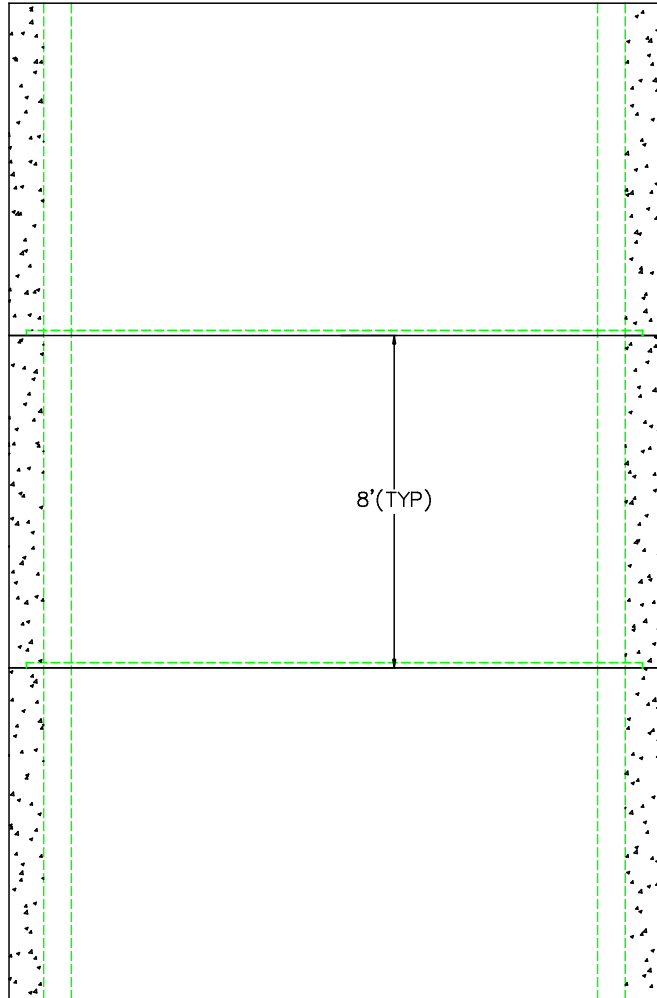

DESIGN NOTES:

1. CONCRETE 5,000 PSI @ 28 DAYS
2. REINFORCEMENT PER ENGINEERS CALCULATIONS
3. DESIGNED FOR H-20 LOADING

