



SCITUATE RAY PRECAST
 120 CLAY PIT ROAD
 MARSHFIELD, MA 02050
 PHONE # 1-800-440-0009
 FAX # 781-837-4320

CONTRACTOR: _____ JOB NAME: _____

DATE: _____ DRAWING: ST-8K-20 DRAWING BY: C. J.

8,000 GALLON SEPTIC TANK

	FLOOR	VERT. FT	FLAT TOP
WEIGHT	12,500 lbs.	3,800 lbs.	16,500 lbs.
VOLUME		1,070 gal.	

DESIGN NOTES:

1. CONCRETE 5,000 PSI. @ 28 DAYS
2. HS-20-44 LOADING WITH 12" - 60" OF COVER
3. REINFORCING ASTM A-615 GRADE 60
4. CONST. JOINT TO HAVE MIN. 1" BUTYL SEALANT
5. EXTERIOR BITUMINOUS COATING AS REQUIRED



NPCA

Precast ... The Concrete Solution.

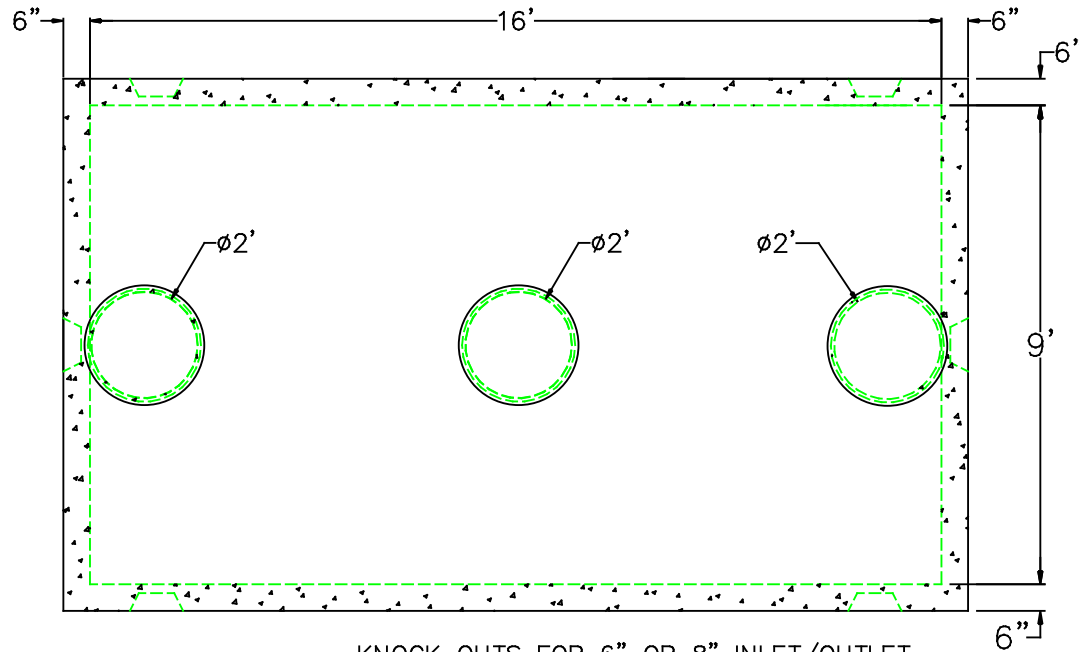

— KNOCK OUTS FOR 6" OR 8" INLET/OUTLET

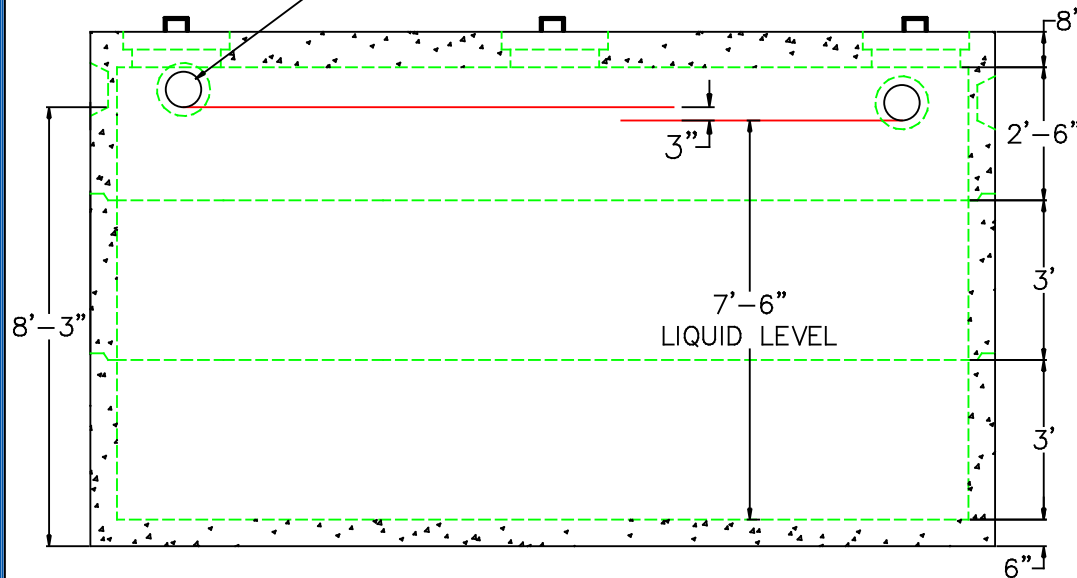

7'-6"
LIQUID LEVEL

